

- Furniture of the "Melodia Sna" is intended for use in equipped (heated) indoor and residential areas. The optimal operating conditions are warm, dry, ventilated rooms at a temperature of 10-28 ° C and a relative humidity of 30-75%.
- To avoid deformation of rigid (Cabinet) furniture elements and fading of the upholstery material, place the furniture away from heat sources at a distance of at least 50 cm. Avoid direct sunlight and excess moisture on the furniture surface.
- Place furniture in the room in such a way as to avoid heating the furniture due to direct sunlight on it for a long time, as well as due to the close proximity to heating devices. Exposure to high temperatures, dryness, or direct rays can cause the wood to dry out and delaminate. Excess moisture also leads to damage to furniture.
- Furniture transported in subzero temperatures should be wiped off immediately with a clean, dry, soft cloth when installed indoors to avoid condensation.
- Use only a soft cloth to wipe dust off furniture surfaces. Clean the product regularly with a vacuum cleaner using special furniture nozzles.
- It is strictly forbidden to place hot and wet objects on the surface of furniture, as well as objects with sharp supports, without insulation supports.
- Protect your furniture from pets, they can spoil the upholstery made of fabric, leather, wood.
- Do not stand on furniture or jump on it, even for children. Do not sit on the headboard.
- Operate the product on a hard, flat surface. During operation, the loads must be evenly distributed over the seating or sleeping area, and the bed must also rest on all supports and the partition for correct load distribution.
- Exceeding the permissible loads will inevitably lead to deformation of the frame and fillers. If the loads on the connecting seams of the cover parts during operation exceed the allowable ones (for each part individually), ruptures of the upholstery threads or stretching associated with their deformation are possible.
- Provide additional protection for your floor covering to avoid marks from supports, mechanisms, and other parts.
- It is forbidden to move furniture by "dragging" in order to avoid mechanical damage. Move the furniture by lifting it slightly above the floor. When moving furniture from place to place, you need to hold the product only by the lower part of the frame.
- Use qualified personnel to assemble furniture. Self-assembly can lead to damage to various parts of the furniture and its mechanisms, as well as their breakdown, which leads to a decrease in the service life.

Eco-leather operating rules:

- Do not use brushes (even with soft bristles) when cleaning the product. To avoid damage to the top layer, do not use cleaning products containing acids, powders containing abrasive particles, or products containing chlorine. Household cleaning fluids or other chemicals can damage the eco-leather. To clean the surface from stains, use a piece of soft cloth or sponge soaked in a mild soap or 20% alcohol solution, immediately after the appearance of contamination. Before cleaning, run the test on a small, inconspicuous area. The stain should not be rubbed on the surface, it should be carefully blotted. After the cleaning procedure, the surface must be blotted with clean water, since soap can leave streaks, and dry with a dry sponge until completely dry. Ironing and drying with warm and hot air (above 25 ° C) is strictly prohibited, because it can lead to deformation of the surface of the coating.
- Be careful! Dyed textiles can stain eco-leather.
- To protect the appearance of the product, you should periodically (1-2 times a year) treat the product with waterproofing and dirt-repellent impregnations for the leather. When choosing an impregnation, be sure to read the instructions for use. If the package contains the indication "not use for PU" (do not use for polyurethane coatings), then this product is not suitable for cleaning eco-leather products.

Rules of operation of the hard (cabinet) elements:

- For cleaning wood surfaces, use only products intended for the care of wood surfaces.
- Protect the product from liquids (especially solvents such as alcohol, acetone, gasoline, etc.).
- Do not place the product near heat sources and avoid direct sunlight.
- Periodically check and, if necessary, tighten the fasteners of the product.

WARRANTY OBLIGATION

1. The warranty applies to furniture made by "Melodia Sna".
2. The product warranty period from the date of purchase is indicated on the label, but not less than 18 months for furniture intended for sitting and lying, and 24 months for cabinet furniture. The warranty period for using furniture in public areas is 1 year.
3. Claims for the appearance of the product, lack of equipment, as well as non-compliance with the order are accepted directly upon receipt of the product. In the future, these claims are not accepted, and all work is carried out only at the expense of the buyer.
4. Warranty service includes repairs and replacement of defective parts of products.

Free warranty repairs are not performed in the following cases:

- Expiration of the warranty period.
- Non-compliance with operating rules.
- The presence of mechanical damage on the product.
- Damage to the product or its loss due to force majeure circumstances (elements, fire, flood, accident, etc.).
- Damage to the product caused by foreign objects, liquids, animals, insects, etc. entering the product.
- The presence of traces of external interference with the product or self-repair of the product, or repair by unauthorized organizations, enterprises or individuals.
- Damage to the product as a result of changes to its design by the user.
- Use of the product for production purposes.
- If the deviation declared by the consumer is not a defect of the current GOST 19917 (for furniture for sitting and lying), GOST 16371 (for Cabinet furniture) and this instruction.

In these cases, service is carried out at the expense of the buyer at the prices of the manufacturer's service department.

Furniture defects are not:

- slight difference in color shades of facing fabrics, as well as coatings made of eco-leather and natural leather;
- a slight difference in color shades and the difference in the pattern of the paintwork (decor);
- light folds on the facing material of soft elements that appear after the removal of loads and disappear after light smoothing by hand;
- folds, assemblies, tightening on the facing material, due to the artistic solution of the product.

The service life of the product is indicated on the label, but not less than 6 years for furniture intended for sitting and lying, and 10 years for Cabinet furniture.

If the product does not lose its operational properties after this period, you can continue using it. Otherwise, the product must be disposed of.

Keep the label or a photo of it for the life of the product.



The factory reserves the right to make changes that do not reduce the quality of the product.



It is possible to preserve the production smell for up to 4 weeks from the moment of opening the package.



Products are declared and certified. The tests were conducted at the Rostest-Moscow industrial product testing center.

OOO "Melodia Sna", Metallistov str., 7a, Penza, Russia
Phone: +7 (8412) 35-00-15

www.melodiasna.ru



FAILURE TO FOLLOW THESE OPERATING RULES, RESULTING IN A LACK OF FURNITURE, IS THE GROUNDS FOR THE LOSS OF THE RIGHT TO WARRANTY SERVICE AND MAY RESULT IN A REDUCED LIFE.

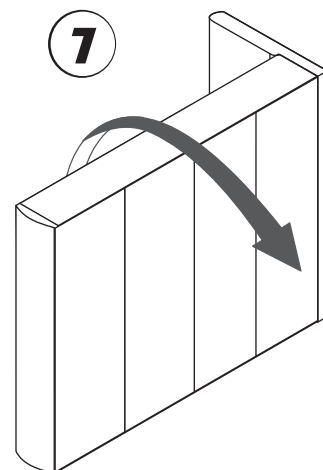
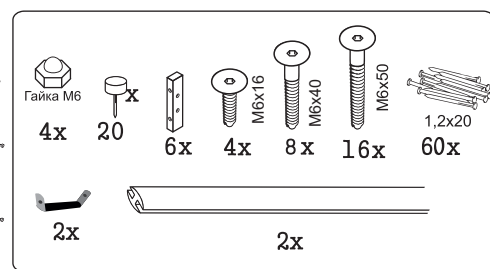
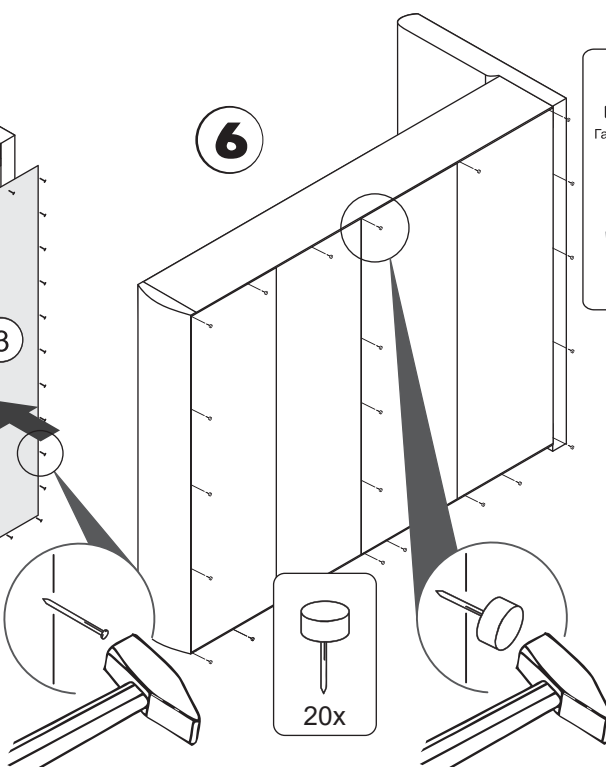
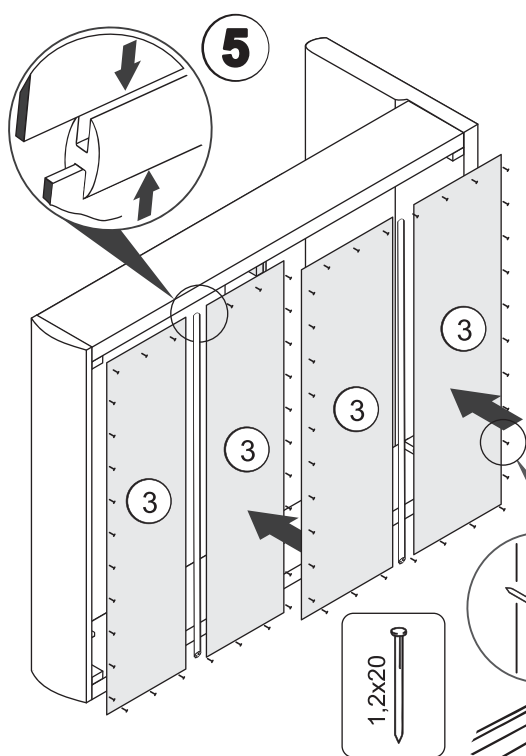
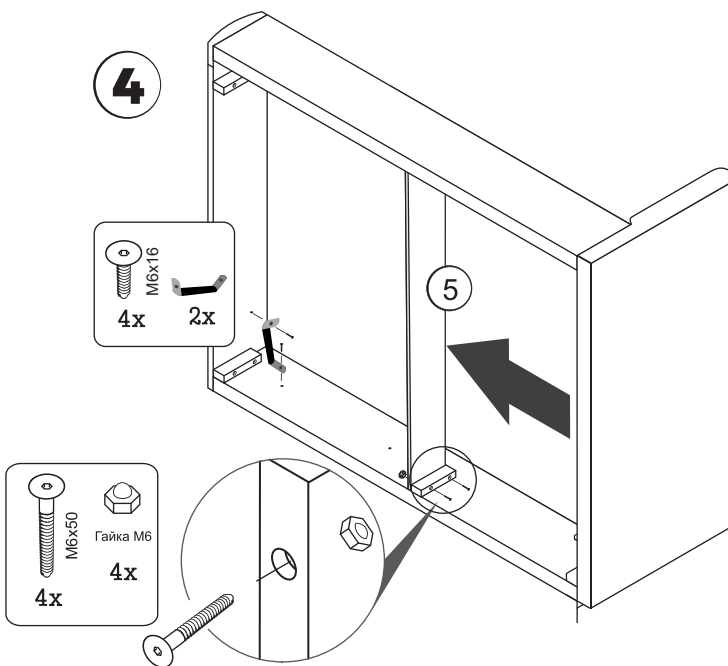
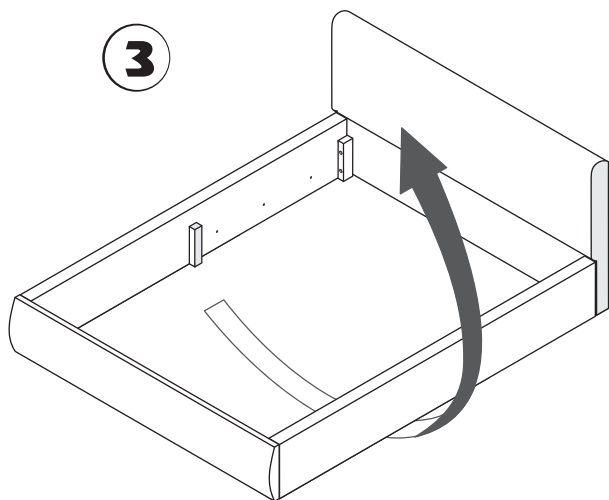
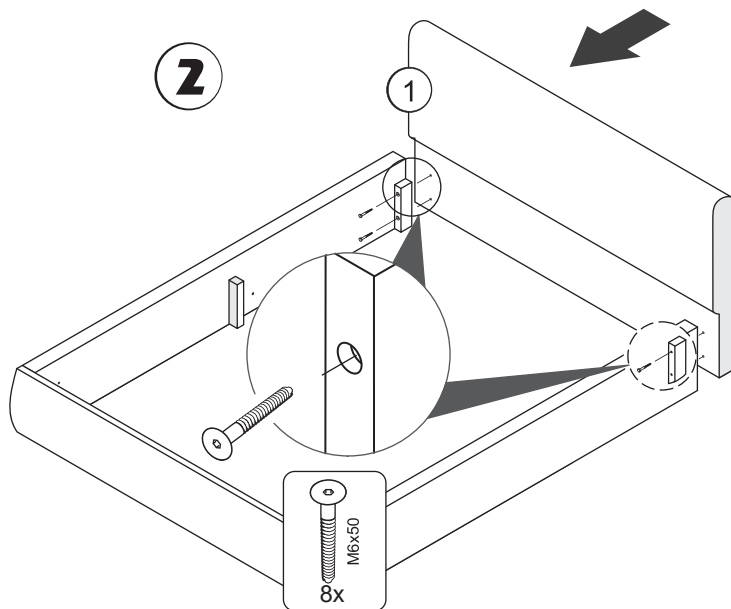
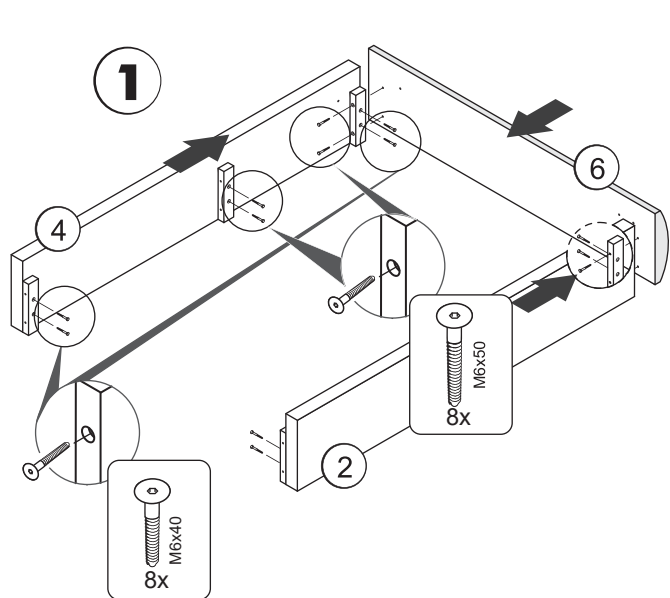

СТЕЛЛА / ТВИСТ
SLELLA / TWIST

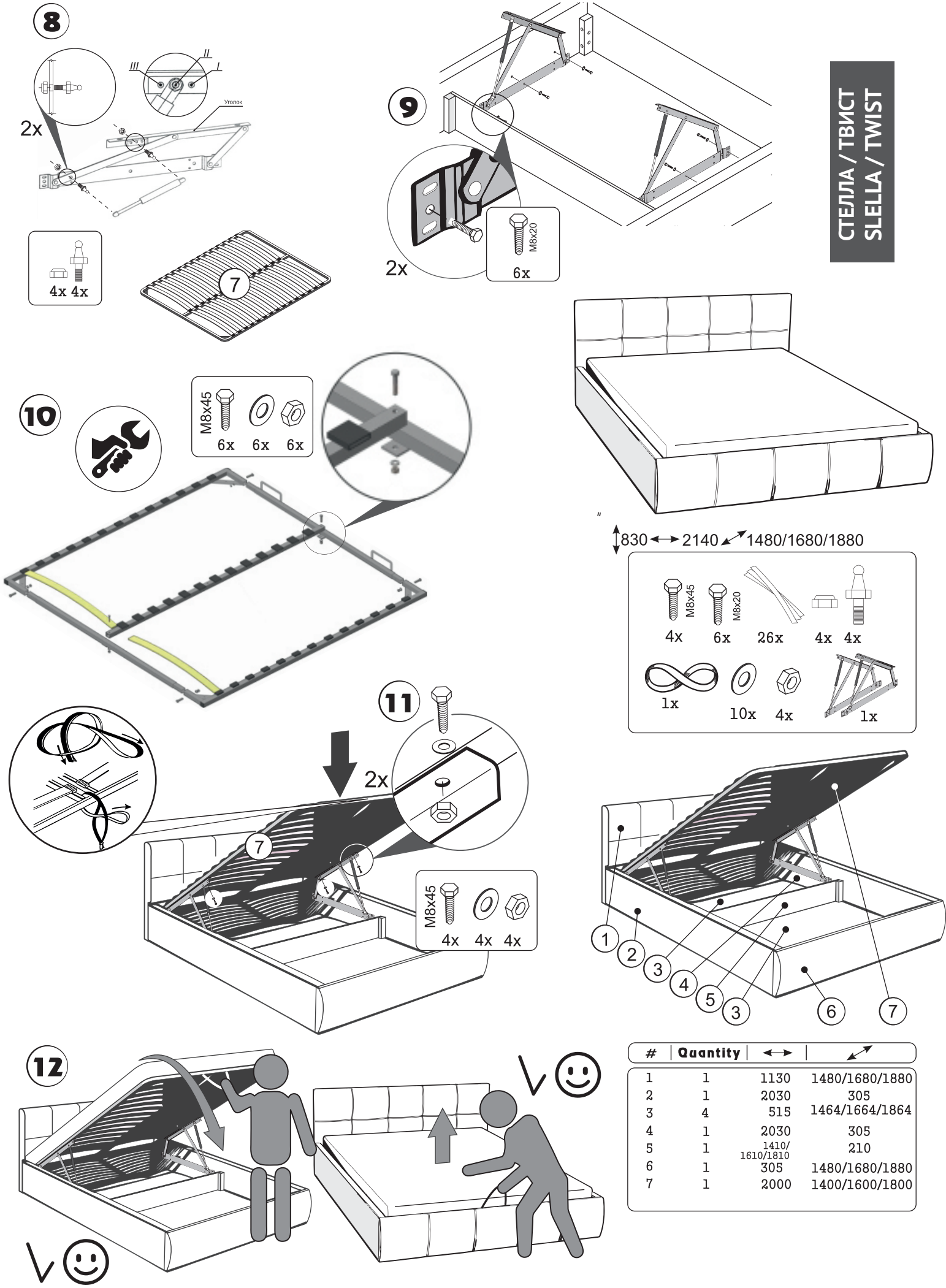

830 2140 1480/1680/1880

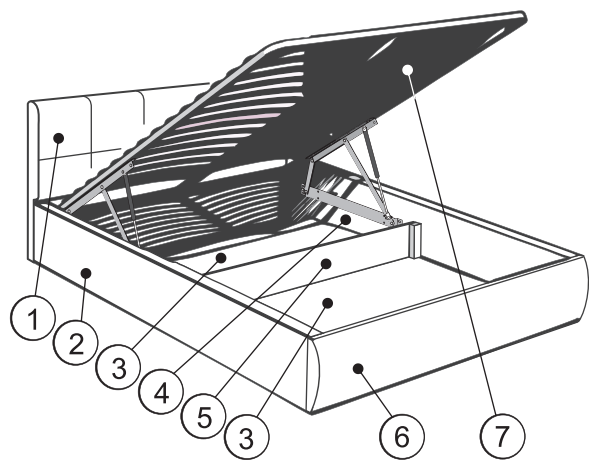
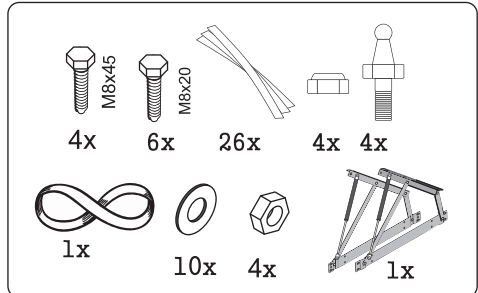

#	Quantity	↔	↗
1	1	1130	1480/1680/1880
2	1	2030	305
3	4	515	1464/1664/1864
4	1	2030	305
5	1	1410/1610/1810	210
6	1	305	1480/1680/1880
7	1	2000	1400/1600/1800